

# Irish Cross Block

## SKILL LEVEL

**BEGINNER**

## Finished Block Size

12" x 12"

**Note:** Templates A and B are at end of pattern, and are printed reversed and without seam allowance to use with paper-backed fusible web.

## Cutting Instructions

**Note:** Read through pattern before cutting.

Light green print (cross)

1 Template A

Medium green print\* (shamrocks)

5 Template B

Dark green print (block background)

1 square 13" x 13"

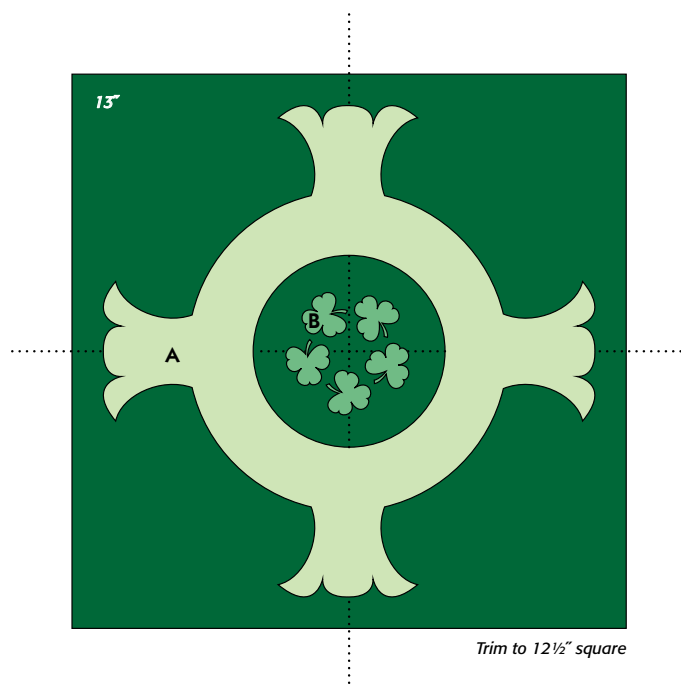
\*Or small shamrock print (see Step 1)

## Making the Block

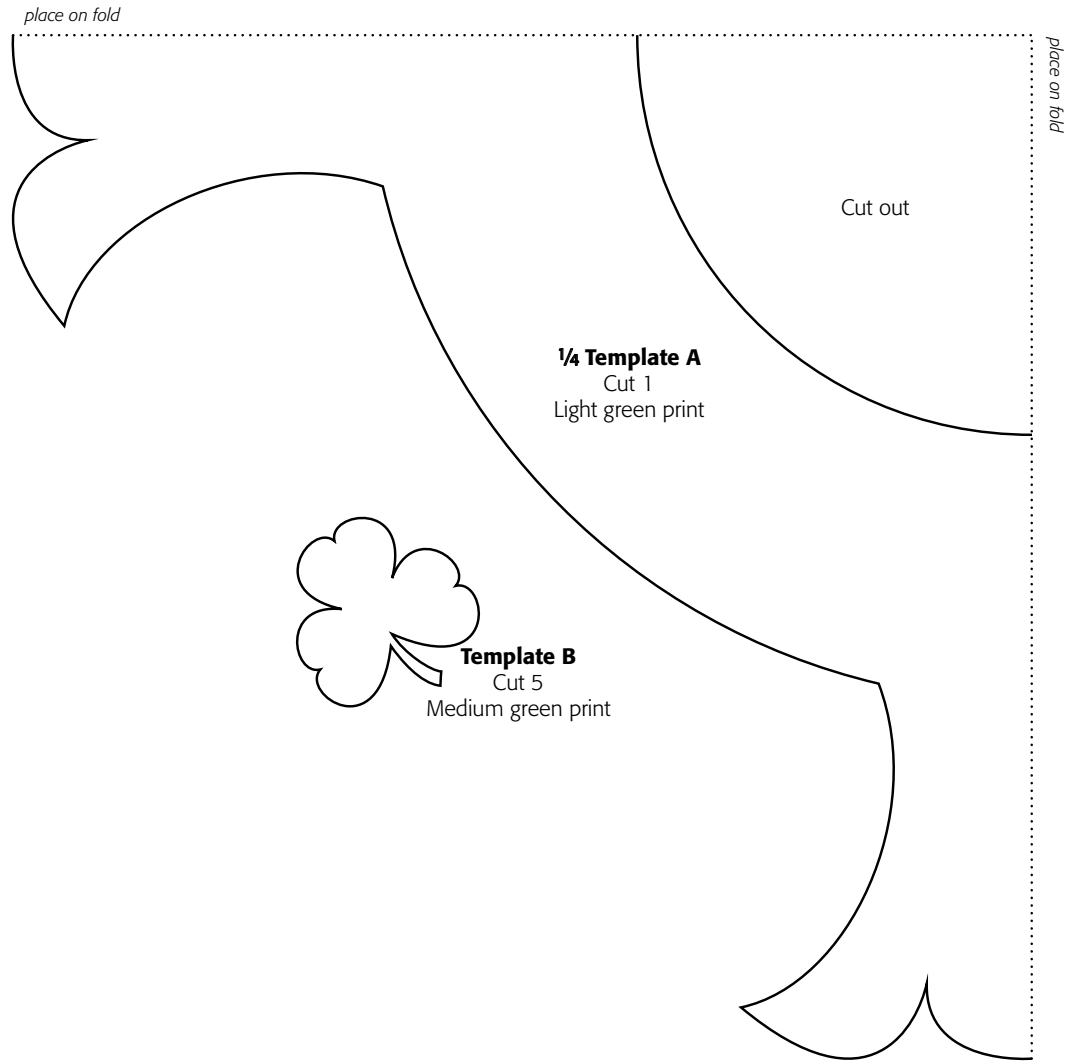
**1** Follow manufacturer's instructions for paper-backed fusible web. Trace Templates A and B on paper side of fusible web. Cut apart, leaving small margin beyond drawn lines. Fuse to wrong side of appropriate fabrics; cut out on drawn lines. If using small shamrock print (shamrocks should be approximately 1"), fuse paper-backed fusible web to wrong side of fabric and then cut out printed shamrocks, rather than using Template B.

**2** Finger-press dark green print 13" x 13" square in half on both length and width; use folds as placement guide. Referring to **diagram**, position A (cross) in center of dark green square and fuse in place. Arrange Bs in a ring in the center of the cross and fuse in place.

**3** Using pink thread and decorative machine stitch (or any other combination of thread and stitch that you prefer), edge-stitch A in place. In similar manner, use monofilament thread to machine straight stitch just inside shamrock edges, including stems. **Trim** to 12½" x 12½", centering cross.



Trim to 12½" square





# I Left My Heart In Ireland Block

## SKILL LEVEL

**CONFIDENT BEGINNER**

## Finished Block Size

12" x 12"

**Note:** Template A is at end of pattern. Template is printed without seam allowance to use with paper-backed fusible web.

## Cutting Instructions

**Note:** Read through pattern before cutting.

White print

1 square 13" x 13"

Assorted green prints, florals, and mottles

1 five-sided shape, approximately 3-5" across\*

Strips and rectangles of varying lengths and widths\*\*

Paper-backed fusible web\*\*\*

\*See Step 1.

\*\*See Steps 1 and 2.

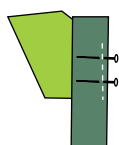
\*\*\*See Step 4.

## Crazy-Piecing Green Fabrics

**1 Note:** You may wish to cut your assorted strips and rectangles as you piece to ensure that they are long enough. Cut one 5-sided shape from assorted green print, floral, or mottle (**Diagram I**). Shape should be approximately 3-5" across. Referring to **Diagram II** and aligning edges, position green strip, right sides together, on one edge of 5-sided shape. Pin in place. Green strip/rectangle must be at least as long as corresponding edge of shape. Using 1/4" seam, sew strip and shape together along aligned edges. Open strip and press (**Diagram III**).



**Diagram I**



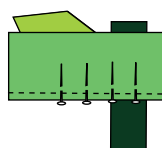
**Diagram II**



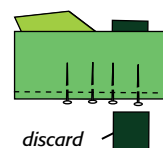
**Diagram III**

**2** Working in a clockwise direction, position a second green strip/rectangle right side down on 5-sided shape so it aligns with second edge of shape and completely crosses just-added strip (**Diagram IV**). Pin in place. Sew strip/rectangle to shape.

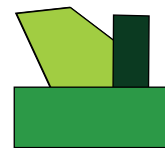
Referring to **Diagram V**, trim excess fabric along edge of strip (end of first strip added). Open strip and press (**Diagram VI**).



**Diagram IV**

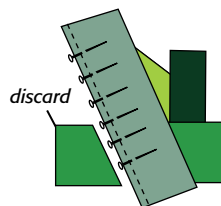


**Diagram V**

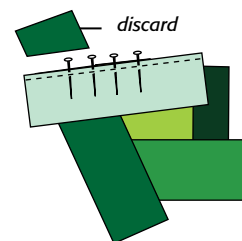


**Diagram VI**

Continue in this manner to add 3rd and 4th strips/rectangles to shape in clockwise direction (**Diagrams VII and VIII**).

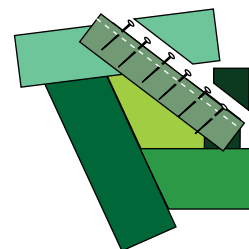


**Diagram VII**



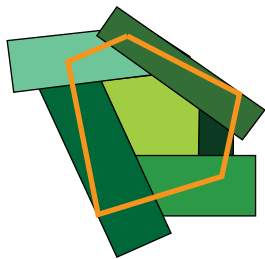
**Diagram VIII**

Add fifth strip to shape, aligning strip with last unsewn edge of shape (**Diagram IX**). Strip/rectangle must completely cross both 1st and 4th strips. Stitch, trim, open, and press as before to complete first round.



**Diagram IX**

3 Draw a new 5-sided shape on pieced fabric (**Diagram X**). Cut along drawn lines to create new pieced shape (**Diagram XI**).

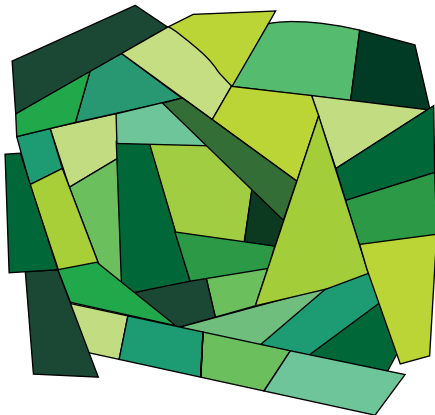


**Diagram X**



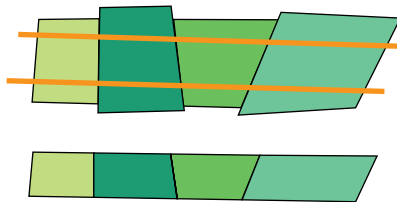
**Diagram XI**

Working **counter-clockwise**, use Step 1 and 2 techniques to add more strips and rectangles to shape. Continue in this manner, alternating clockwise and counter-clockwise rounds, until pieced fabric is approximately 11" x 12" (**Diagram XII**).



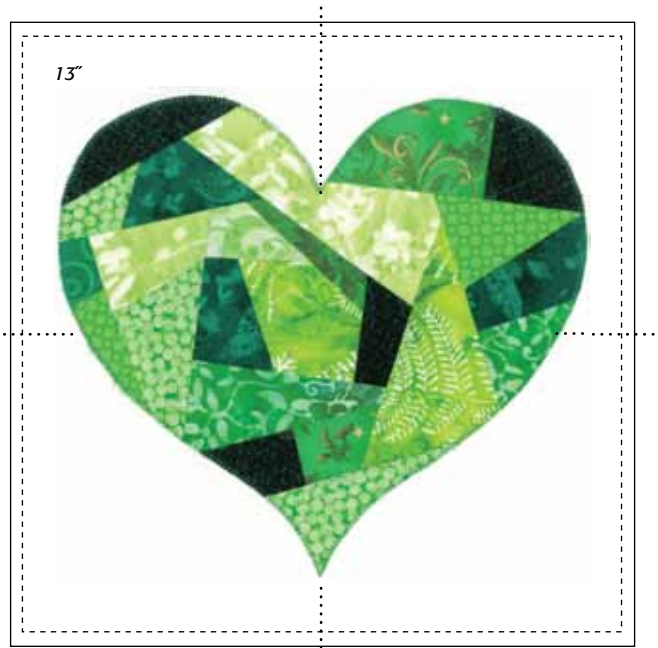
**Diagram XII**

**Tip:** To add a greater variety of fabrics, you may wish to stitch 2 or more fabrics together (with non-parallel seams) and then cut a strip or rectangle from the pieced fabric (**Diagram XIII**).



**Diagram XIII**

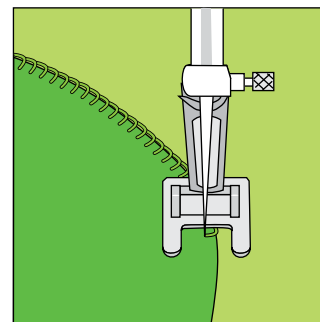
4 **Note:** Follow manufacturer's instructions for paper-backed fusible web. Template A is a hollow heart shape to keep bulk of fusible web to a minimum. Trace A on paper side of fusible web. Cut out, leaving small margin beyond outer drawn line. Cut out center. Fuse to wrong side of pieced fabric. Cut out heart on outer drawn line only. Finger-press white print 13" square on both length and width. Use folds as placement guide. Center heart on square and fuse in place (**Diagram XIV**).



**Diagram XIV**

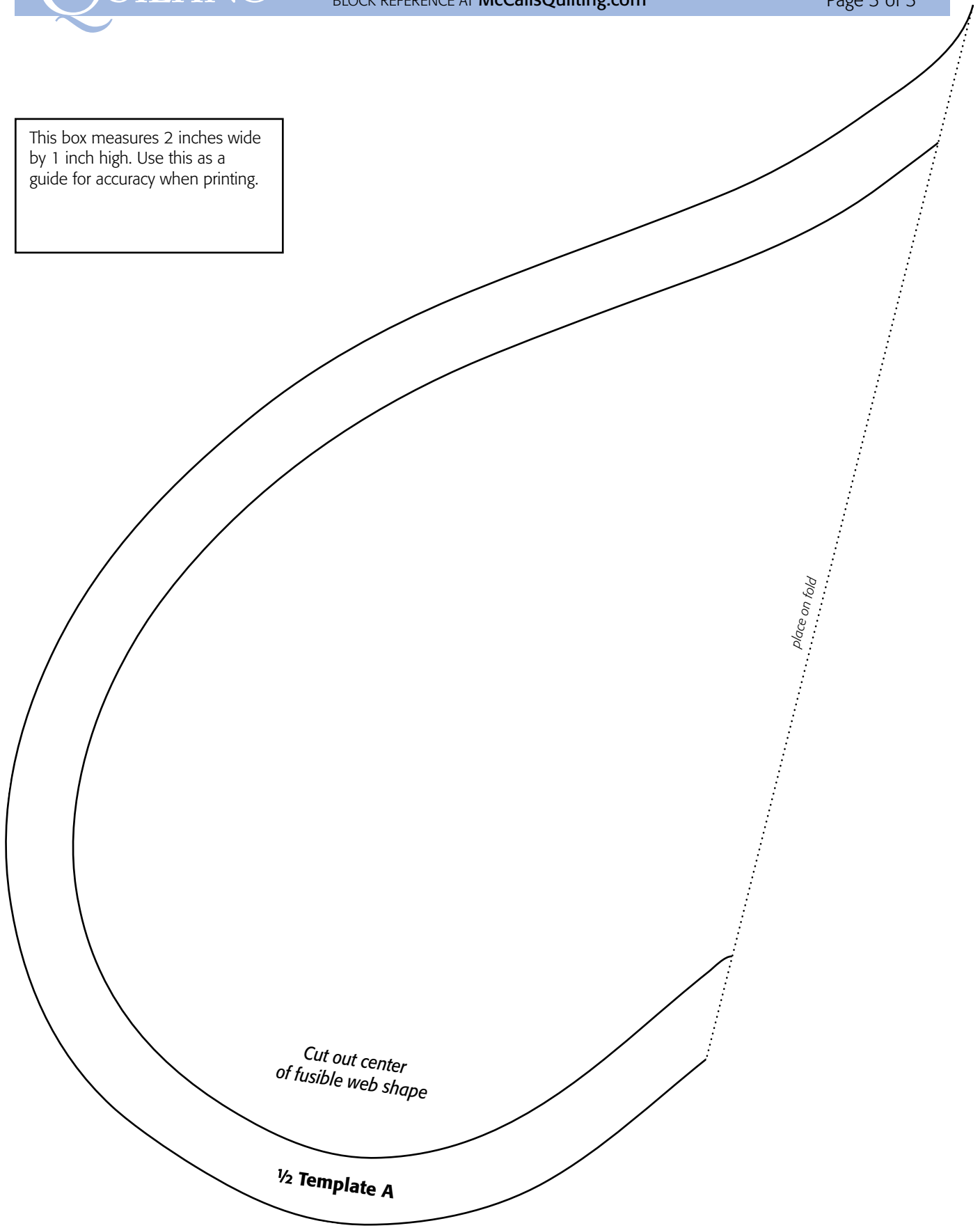
*Trim to 12½" square*

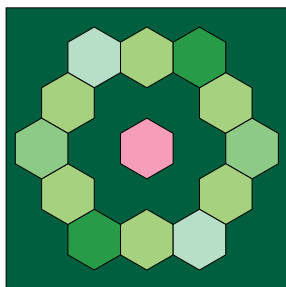
Edge-stitch using machine blanket stitch and green thread (**Diagram XV**). Trim square to 12½" x 12½", centering heart.



**Diagram XV**

This box measures 2 inches wide by 1 inch high. Use this as a guide for accuracy when printing.





# Fairy Ring Block

## SKILL LEVEL

**CONFIDENT BEGINNER**

## Finished Block Size

12" x 12"

**Note:** Templates A and B are at end of pattern.

## Cutting Instructions

Heavy paper or cardstock (paper hexagons)

13 Template A\*

Light green/pink floral (hexagons)

6 Template B

3 assorted light green prints (hexagons)—**cut from each:**

2 Template B

Novelty fabric (center hexagon)

1 Template B

Dark green mottle (block background)

1 square 13" x 13"

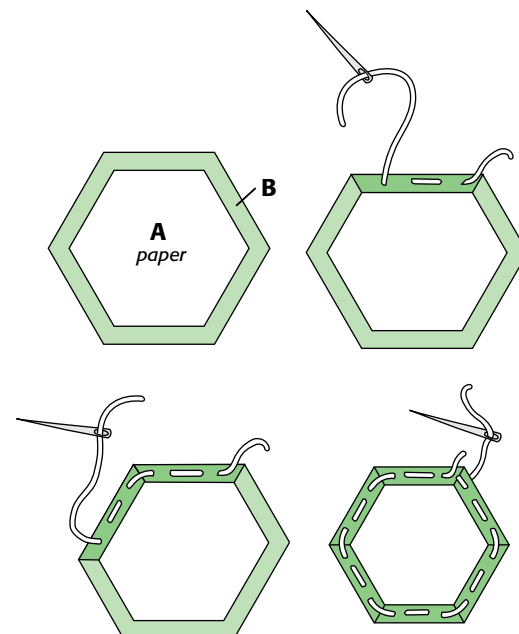
\*You may prefer to purchase paper hexagons that are 1 1/4" on a side, rather than making your own. [Paperpieces.com](http://Paperpieces.com) is one website that carries paper hexagons this size.

## Making the Block

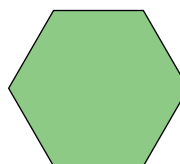
**1** Trace Template A on heavy paper or cardstock. Cut out on marked line to make paper hexagon. Make 13.

**2** Referring to **Diagram I**, place paper hexagon on wrong side of fabric B, centering. Fold edges of B over A and baste in place, stitching through fabric and paper, to make basted hexagon. Make 13 total (**Diagram II**).

**3** Align 2 basted hexagons, right sides together, and whip-stitch one edge, taking tiny stitches that just catch fabric folds (**Diagram III**). Hexagons should lay flat when opened.

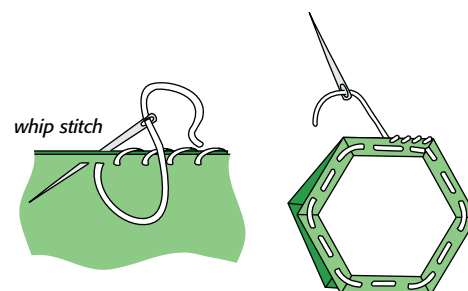


**Diagram I**



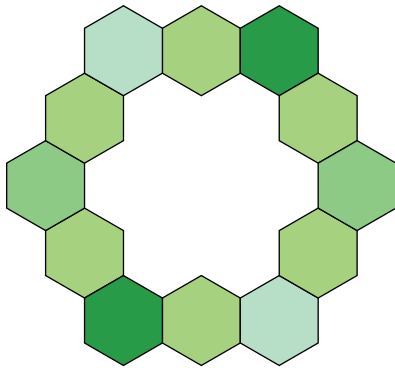
Make 13 total

**Diagram II**



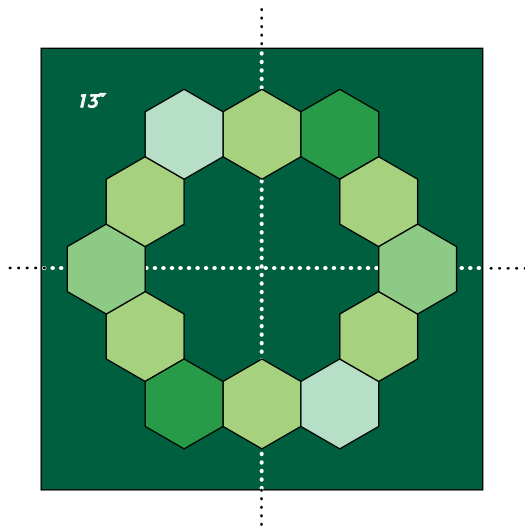
**Diagram III**

4 Referring to **Diagram IV**, whip-stitch together 6 green/pink floral and 6 assorted green print basted hexagons, alternating and being sure to sew correct edges together to form ring. Make 1. With right side down, spray ring with starch or starch alternative and press with papers still in place. When ring is cool remove basting and papers, keeping outer edges of hexagons folded under. In same manner, starch and press remaining hexagon and remove paper. Papers can be reused.



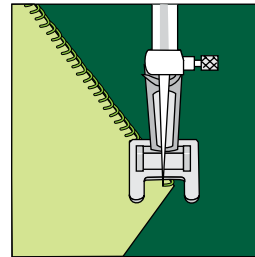
**Diagram IV**

5 Fold green mottle 13" square in half on both length and width; use folds as placement guide. Center ring on green mottle square and pin or baste in place (**Diagram V**).



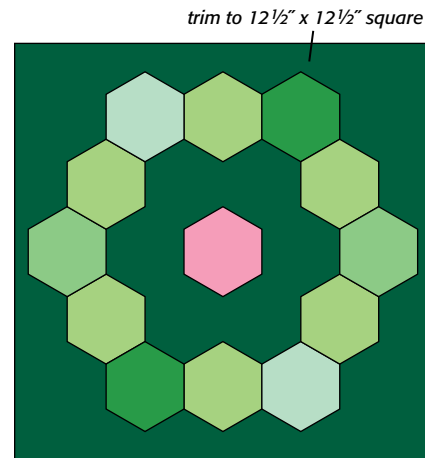
**Diagram V**

Using machine blanket stitch (**Diagram VI**), edge-stitch ring in place. You may wish to use a wool or other thick thread for extra visibility.

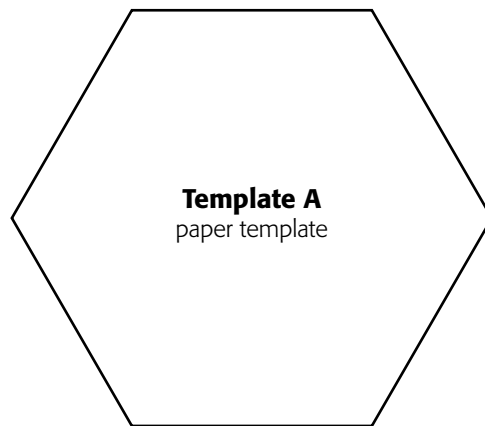
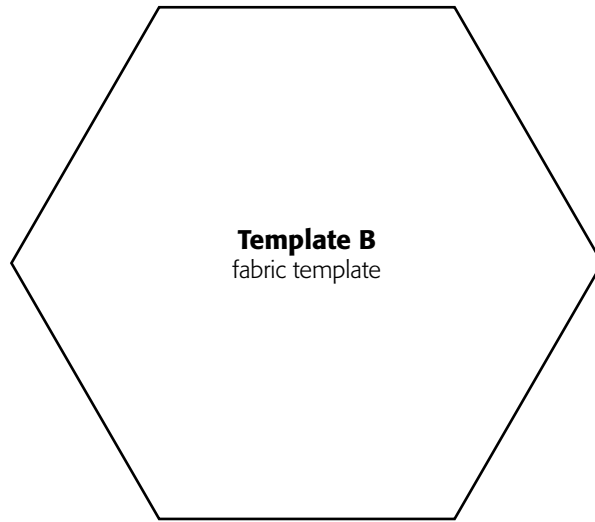


**Diagram VI**

6 Center novelty fabric hexagon in ring and machine blanket stitch in place. Press square, and trim to 12½" x 12½", centering ring, to complete Fairy Ring Block.



**Diagram VII**







# Folktale Circle Block

**SKILL LEVEL**  
**BEGINNER**

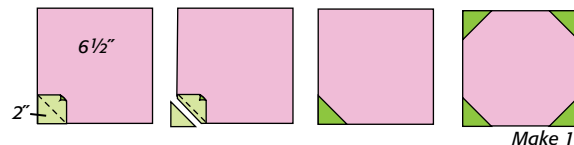
**Finished Block Size**  
12" x 12"

## Cutting Instructions

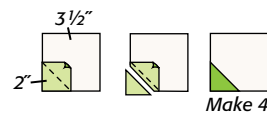
- Green batik (ring)
  - 4 rectangles  $3\frac{1}{2}$ " x  $6\frac{1}{2}$ "
  - 8 squares 2" x 2"
- Pink novelty print (center)
  - 1 square  $6\frac{1}{2}$ " x  $6\frac{1}{2}$ "
- White print (corners)
  - 4 squares  $3\frac{1}{2}$ " x  $3\frac{1}{2}$ "

## Piecing the Block

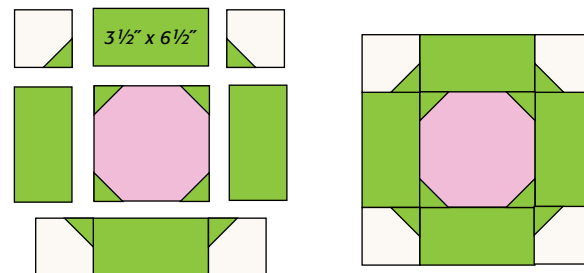
- 1 Draw diagonal line on wrong side of green 2" square. Place marked square on pink  $6\frac{1}{2}$ " square, right sides together, aligning raw edges (**Diagram I**). Sew on marked line; trim away and discard excess fabric. Open and press. Repeat on remaining corners of pink square to make block center.
- 2 Using Step 1 technique, add 1 green square to white  $3\frac{1}{2}$ " square to make pieced square (**Diagram II**). Make 4.
- 3 Sew 3 rows using pieced squares, green rectangles, and block center (**Diagram III**). Sew rows together to complete Folk Tale Circle Block.



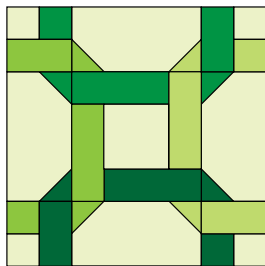
**Diagram I**



**Diagram II**



**Diagram III**



# Celtic Twist Block

**Skill Level**  
CONFIDENT BEGINNER

**Finished Block Size**  
12" x 12"

**Cutting Instructions**  
(cut in order listed)

White/green print (background)

4 rectangles 3½" x 6½"

1 square 3½" x 3½"

4 squares 2" x 2"

Dark green swirl print, medium lime mottle, light green floral, and dark green texture (links)—cut from each:

1 strip 2" x 5"

1 rectangle 2" x 3½"

3 squares 2" x 2"

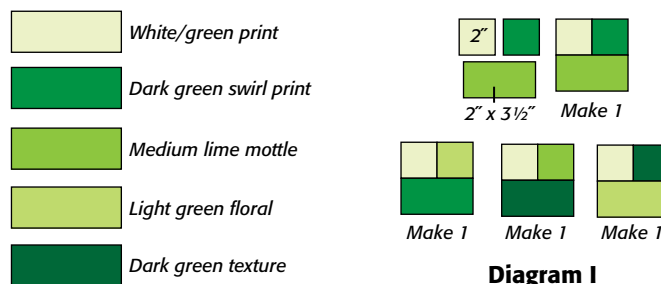
**Piecing the Block**

**1** Referring to **Diagram I**, sew together 1 white/green print 2" square, 1 dark green swirl print 2" square, 1 dark green swirl print 2" square, and 1 medium lime mottle 2" x 3½" rectangle to make pieced square. Make 4 total in fabric arrangements shown.

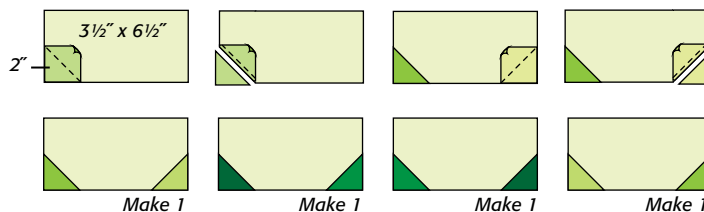
**2** Draw diagonal line on wrong side of lime 2" square. Place marked square on white/green 3½" x 6½" rectangle, right sides together, aligning raw edges (**Diagram II**). Stitch on drawn line; trim away and discard excess fabric. Open and press. Repeat on opposite end of rectangle with light green floral 2" square to make pieced rectangle. Make 4 total in fabric arrangements shown.

**3** Referring to **Diagram III-A** for fabric placement, lay out 2" x 5" strips around white/green 3½" square. Stitch first seam as shown, starting approximately 2" (dot) from top left corner of center square. Open strip and press partial seam. Following seaming order, add remaining strips. Complete partial seam to make block center (**Diagram III-B**).

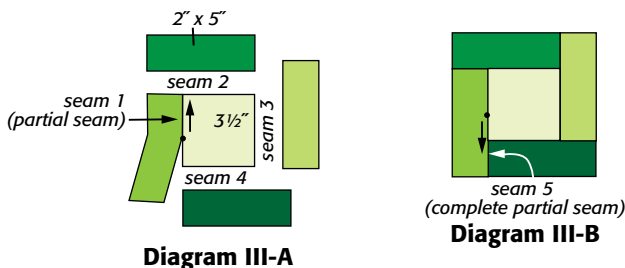
**4** Arrange pieced squares, pieced rectangles, and block center as shown (**Diagram IV**). Check placement to make sure that links appear to interlock. Sew 3 rows, and then sew rows together to make Celtic Twist Block.



**Diagram I**

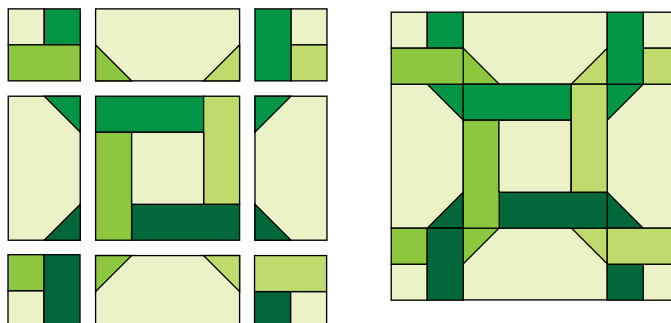


**Diagram II**

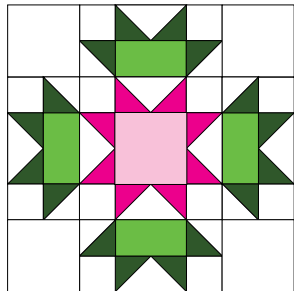


**Diagram III-A**

**Diagram III-B**



**Diagram IV**



# Connemara Flower Block

**SKILL LEVEL**  
**CONFIDENT BEGINNER**

**Finished Block Size**  
12" x 12"

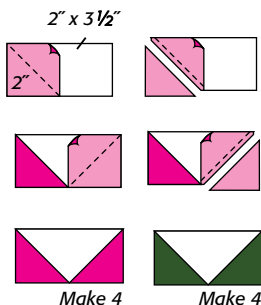
## Cutting Instructions

(cut in order listed)

- Pink mottled batik (flower petals)
  - 8 squares 2" x 2"
- White-on-white print (background)
  - 4 squares 3½" x 3½"
  - 8 rectangles 2" x 3½"
  - 4 squares 2⅜" x 2⅜"
  - 12 squares 2" x 2"
- Green mottled batik (leaves)
  - 4 squares 2⅜" x 2⅜"
  - 8 squares 2" x 2"
- Light green print (leaves)
  - 4 rectangles 2" x 3½"
- Light pink fairy print (center)
  - 1 square 3½" x 3½", fussy-cut centering fairy

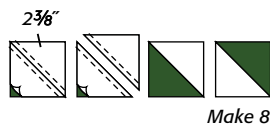
## Piecing the Block

**1** Draw diagonal line on wrong side of pink 2" square. Place marked square on white 2" x 3½" rectangle, right sides together, aligning raw edges (**Diagram I**). Stitch on drawn line; trim away and discard excess fabric. Open and press. Repeat on opposite end of rectangle to make pieced rectangle. Make 4. In same manner, make 4 pieced rectangles using green batik 2" squares and white rectangles.



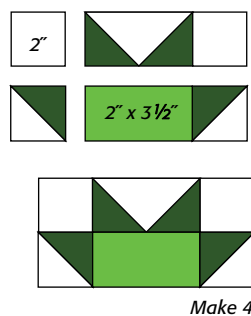
**Diagram I**

**2** Draw diagonal line on wrong side of white 2⅜" square. Referring to **Diagram II**, place marked square on green batik 2⅜" square, right sides together. Sew ¼" seam on each side of marked line; cut apart on marked line. Open and press to make 2 pieced squares. Make 8.



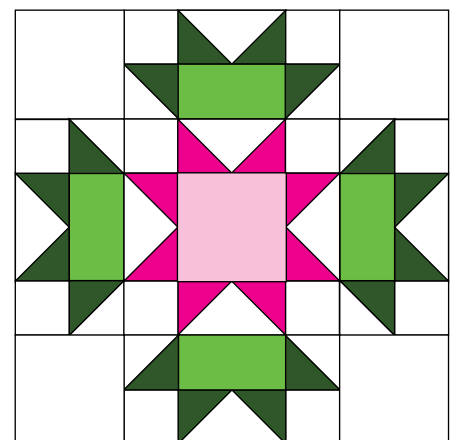
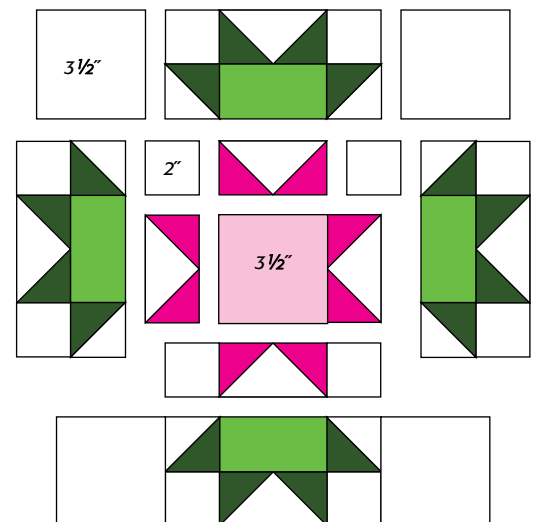
**Diagram II**

**3** Referring to **Diagram III** and watching orientation of pieced squares, stitch together 2 white 2" squares, 2 green/white pieced squares, 1 green/white pieced rectangle, and 1 light green print rectangle to make block unit. Make 4.



**Diagram III**

**3** Referring to **Diagram IV**, sew 3 rows using 4 white 2" squares, 4 pink/white pieced rectangles, and light pink fairy print 3½" square. Sew rows together to make block center. Add block unit to each side of block center. Sew white 3½" squares to ends of remaining block units and stitch to top and bottom to make Connemara Flower Block.



**Diagram IV**



# Celtic Knot Block

## SKILL LEVEL

**INTERMEDIATE**

### Finished Block Size

12" x 12"

**Note:** Celtic knot motif is at end of pattern.

## Cutting Instructions

Dark green mottle (knot)

1 bias-cut strip 1½" x 120"  
(from 1 square 14" x 14"\*)

White/green print (background)

1 square 14" x 14"

Paper-backed fusible web, ½"-wide

2 strips ½" x 56"

Bias bar, ½" (optional)

Small appliqué iron (optional)

\*To learn how to make a continuous bias-cut strip from a square, visit [McCallsQuilting.com](http://McCallsQuilting.com), click on Videos, then Basic Quilting Classes, and finally on Making Continuous Bias.

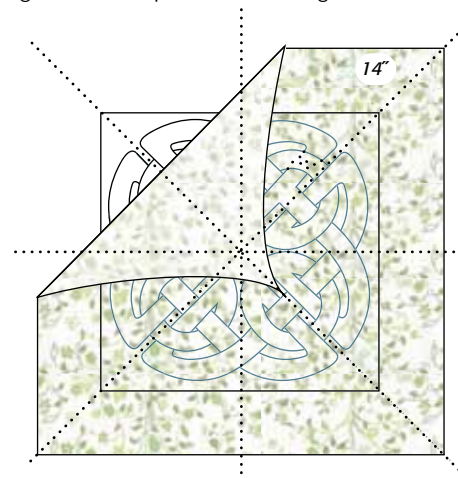
## Appliquing the Block

**1** Referring to **Diagram I**, fold dark green 1½" x 120" bias-cut strip in half, **wrong** sides together. Stitch ½" from fold. Trim seam allowance to ⅛". Press tube flat, centering seam allowance on back so raw edge isn't visible from front. Using ½" bias bar makes pressing faster and easier. From pressed tube, cut 2 strips each 56" long. Following manufacturer's instructions, fuse fusible-web 56" strip to back (seamed) side of dark green 56" strip. Make 2.



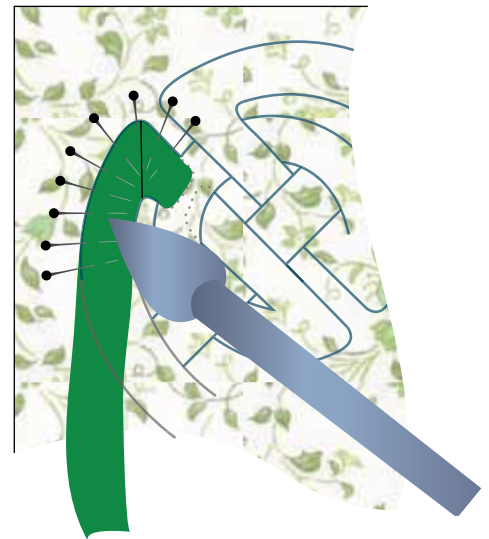
**Diagram I**

**2** **Note:** The white/green background square is cut oversized to allow for shrinkage during appliqué. Finger-press white 14" square in half on both length and width and diagonally twice; use folds as placement guide. With motif beneath fabric and referring to **Diagram II**, trace motif onto background square, aligning motif with fold lines on square as shown. Be sure to trace dashed lines indicating where strips begin and end. You may find that a window or light box is helpful when tracing.



**Diagram II**

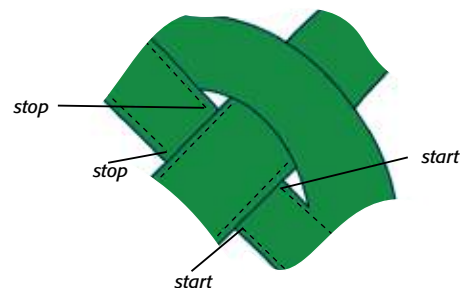
**3** Follow manufacturer's instructions for paper-backed fusible web. Begin by placing 1 strip end on background square where indicated by dashed lines on motif (**Diagram III**). Working a couple of inches at a time, position strip on tracing, pinning one edge as needed (leaving one side free for iron). Being sure **not** to fuse strip where another strip will cross beneath, use an iron to tack positioned section of strip in place. A small appliqué iron is helpful when tacking. At corners, fold strip over onto itself, tucking excess strip beneath. Continuing in this manner, position and tack entire strip in place, weaving strip under and over itself as indicated on motif. When you reach the beginning, trim strip end and tuck it under crossing strip.



**Diagram III**

**4** Using Step 3 technique, position and fuse 2nd strip, weaving under and over both strips to form knot as shown. Fuse all strips in place.

**5** Using matching thread and a short stitch length, straight stitch along all strip edges, starting and stopping where strip goes under another strip (**Diagram IV**).



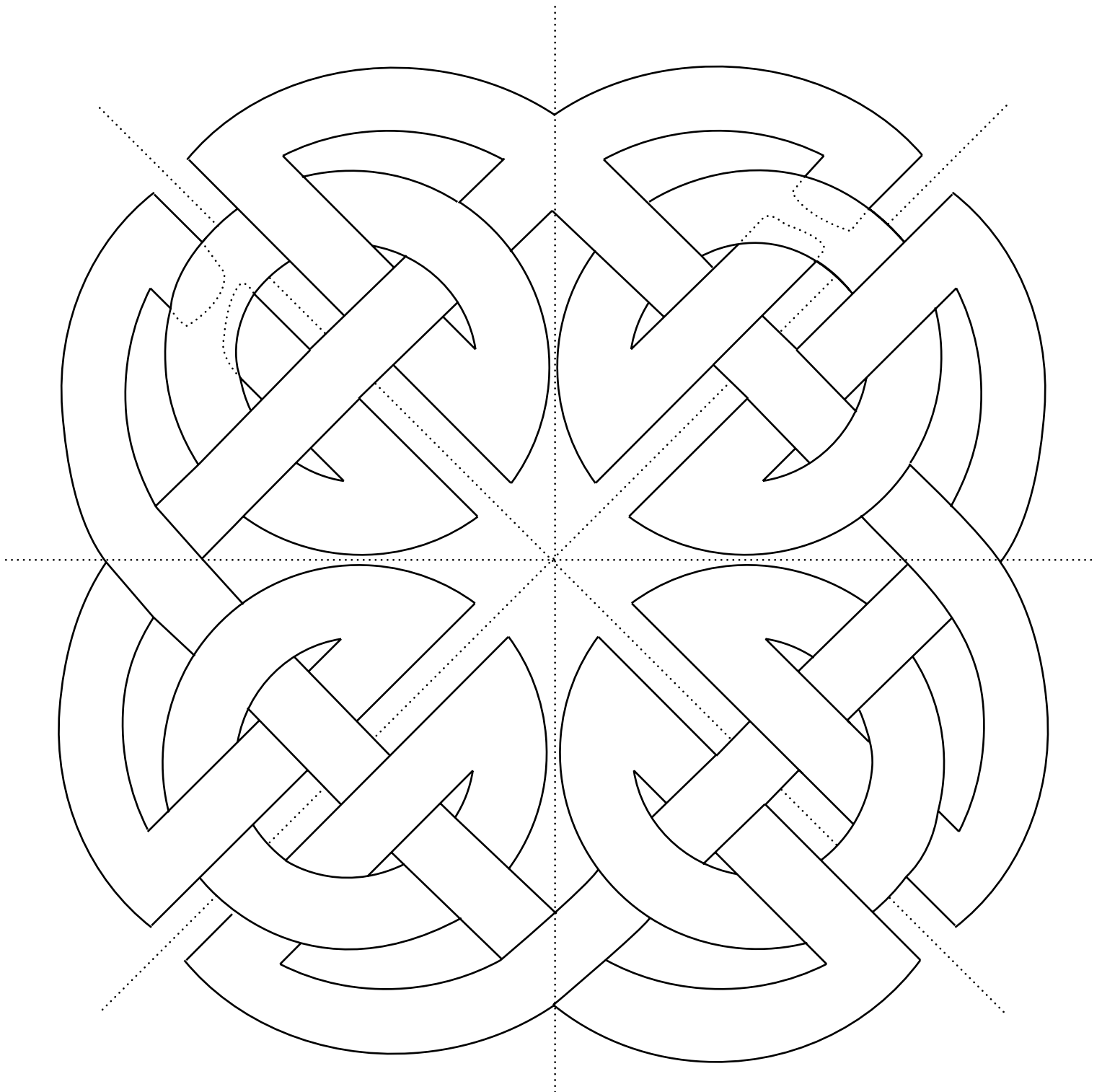
**Diagram IV**

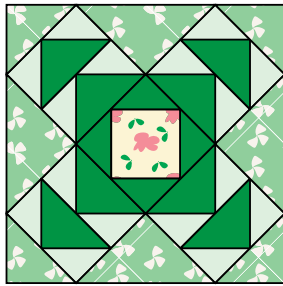
- 6 With Celtic knot centered, **trim** block to 12½" x 12½"  
(Diagram V).



*Trim to 12½" x 12½"*

**Diagram V**





# Treasures from Ireland Block

**SKILL LEVEL**  
**CONFIDENT BEGINNER**

**Finished Block Size**  
12" x 12"

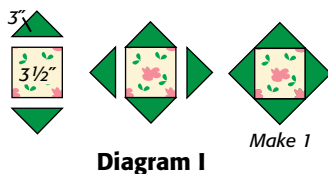
**Cutting Instructions**  
(cut in order listed)

- = cut in half diagonally
- ⊠ = cut in half twice diagonally
- Green mottle (center, geese)
  - 2 squares 3" x 3" □
  - 8 rectangles 2<sup>5</sup>/<sub>8</sub>" x 4<sup>3</sup>/<sub>4</sub>"
- Cream/pink floral (center square)
  - 1 square 3<sup>1</sup>/<sub>2</sub>" x 3<sup>1</sup>/<sub>2</sub>"
- Pale green mottle (geese backgrounds)
  - 16 squares 2<sup>5</sup>/<sub>8</sub>" x 2<sup>5</sup>/<sub>8</sub>"
- Green shamrock print (setting triangles)
  - \*1 square 8" x 8" □
  - \*2 squares 4<sup>1</sup>/<sub>4</sub>" x 4<sup>1</sup>/<sub>4</sub>" □

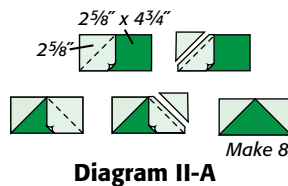
\*The green shamrock print setting triangles on all edges and corners are cut oversized for subsequent trimming.

**Piecing the Block**

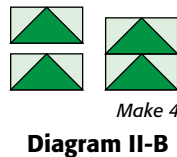
**1** Referring to **Diagram I**, sew green mottle 3" half-square triangles to sides of cream/pink floral 3<sup>1</sup>/<sub>2</sub>" square to make block center.



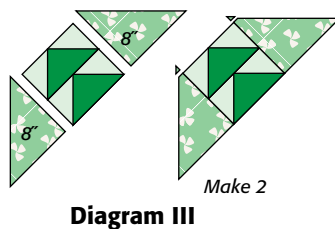
**2** Draw diagonal line on wrong side of pale green mottle 2<sup>5</sup>/<sub>8</sub>" square. Place marked square on green mottle 2<sup>5</sup>/<sub>8</sub>" x 4<sup>3</sup>/<sub>4</sub>" rectangle, right sides together, aligning raw edges (**Diagram II-A**). Stitch on drawn line; trim away and discard excess fabric. Open and press.



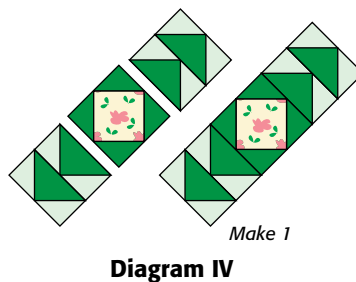
Repeat on opposite end of rectangle to make pieced rectangle. Make 8. Stitch 2 pieced rectangles together to make flying geese unit (**Diagram II-B**). Make 4.



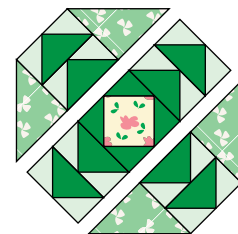
**3** Referring to **Diagram III**, stitch 2 green shamrock print 8" quarter-square triangles to flying geese unit, aligning as shown. Trim points of triangles even with flying geese unit to make geese/triangle unit. Make 2.



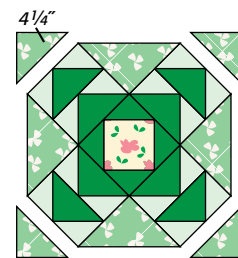
**4** Sew 2 flying geese units to opposite sides of block center to make pieced strip (**Diagram IV**).



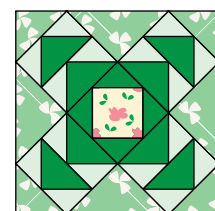
**5** Referring to **Diagram V-A**, stitch together geese/triangle units and pieced strip.



Stitch green shamrock 4<sup>1</sup>/<sub>4</sub>" half-square triangles to corners (**Diagram V-B**).



Trim block to 12<sup>1</sup>/<sub>2</sub>" square, centering (**Diagram V-C**), to complete Treasures from Ireland block.





# Seven Lucky Shamrocks Block

**SKILL LEVEL**  
**BEGINNER**

**Finished Block Size**  
12" x 12"

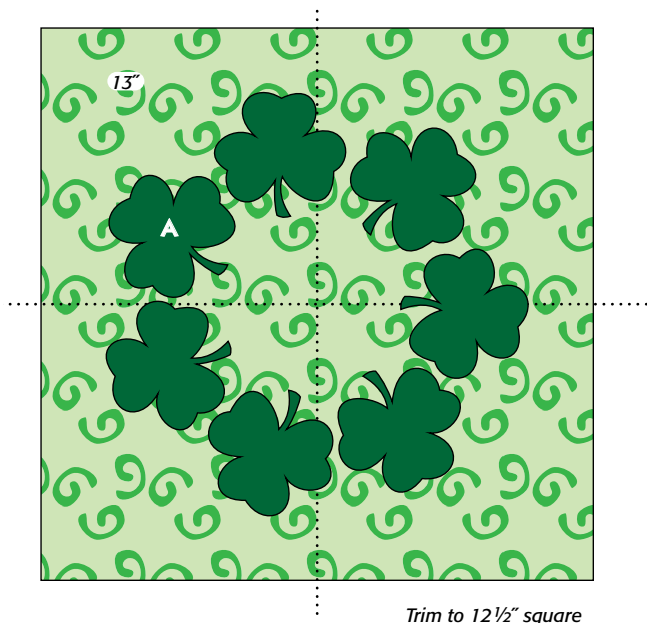
**Note:** Template A is at end of pattern, and is printed reversed and without seam allowance to use with paper-backed fusible web.

### Cutting Instructions

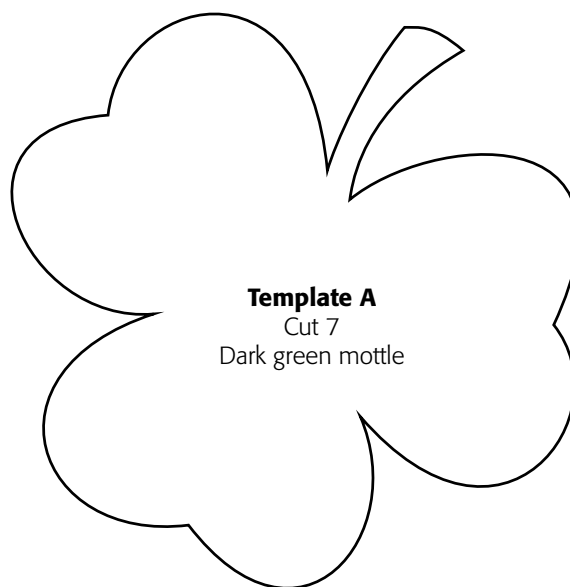
**Note:** Read through pattern before cutting.  
Dark green mottle (shamrocks)  
7 Template A  
Light green/white print (block background)  
1 square 13" x 13"

### Making the Block

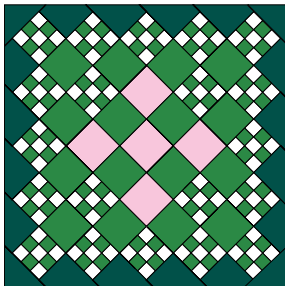
- 1 Follow manufacturer's instructions for paper-backed fusible web. Trace 7 Template A shamrocks on paper side of fusible web. Cut apart, leaving small margin beyond drawn lines. Fuse to wrong side of dark green mottle; cut out on drawn lines.
- 2 Finger-press light green/white print 13" square in half on both length and width; use folds as placement guide. Referring to **diagram** and remembering that block will be trimmed to unfinished size of 12½" square, arrange shamrocks in a ring in center of light green square and fuse in place.
- 3 Using green thread and very small machine satin stitch (or any other combination of thread and stitch that you prefer), stitch edges of As in place. **Trim** to 12½" x 12½", centering shamrock ring.



*Trim to 12½" square*







# Fairies and Flower Petals Block

**SKILL LEVEL**  
**INTERMEDIATE**

**Finished Block Size**  
12" x 12"

## Planning

For a quicker version of this block, just cut 20 squares 2" x 2" from the white/green print and use them in place of the 9-patches. If you choose to do this you won't need the 1" strips.

Any novelty print with motifs that will fit into a 1½" finished square can substitute for the fairy print. To fussy-cut the fairy print squares, cut a 2" square of see-through template plastic; place template on fabric, centering as desired. Mark around edge of template and cut out.

The dark green setting triangles on all edges and corners are cut oversized for subsequent trimming.

## Cutting Instructions

(cut in order listed)

☒ = cut in half twice diagonally

☑ = cut in half diagonally

White/green print (9-patches)

2 strips 1" x width of fabric (WOF)

1 strip 1" x 21-22"

Green swirl print (9-patches, squares)

1 strip 1" x WOF

2 strips 1" x 21-22"

16 squares 2" x 2"

Fairy print (fussy-cut squares)

5 squares 2" x 2", fussy-cut centered on fairies

Dark green print (squares, setting triangles)

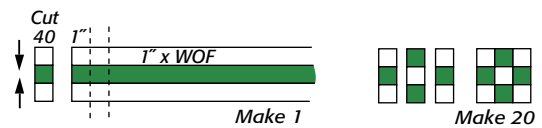
3 squares 5½" x 5½" ☒

2 squares 4" x 4" ☑

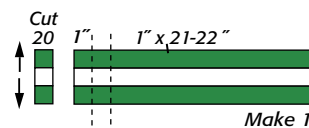
4 squares 2" x 2"

## Piecing the Block

1 Referring to **Diagram I-A**, sew together 2 white/green print and 1 green swirl print WOF strips to make strip set. Make 1. Press in direction of arrows. Cut into 40 segments 1" wide. In same manner, use 2 green swirl and 1 white/green 21-22" strips to make strip set. Make 1. Press, and cut into 20 segments 1" wide. Sew 3 segments together to make 9-patch (**Diagram I-B**). Make 20.

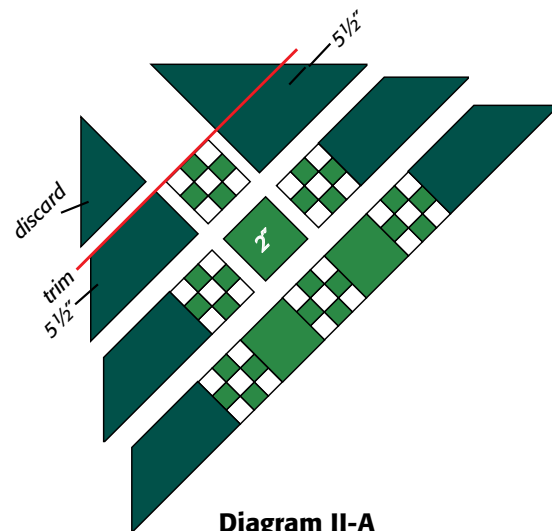


**Diagram I-B**



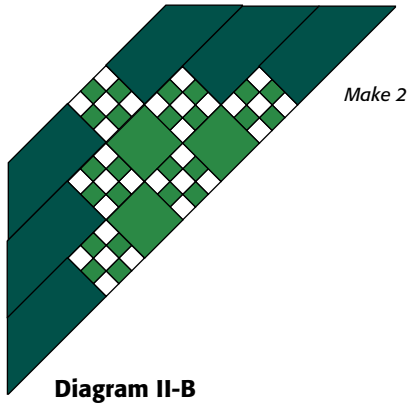
**Diagram I-A**

2 Referring to **Diagram II-A**, sew 3 diagonal rows using dark green 5½" quarter-square triangles, 9-patches, and green swirl 2" squares, trimming triangles even with each row.

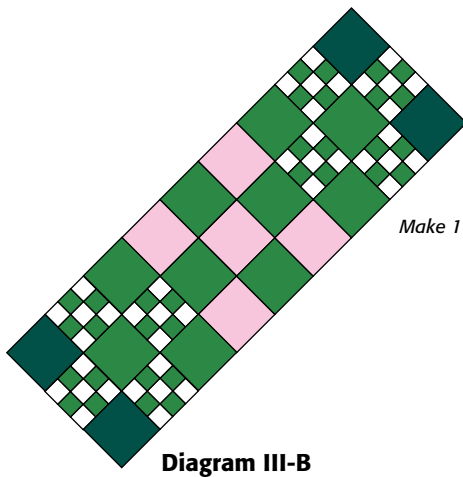
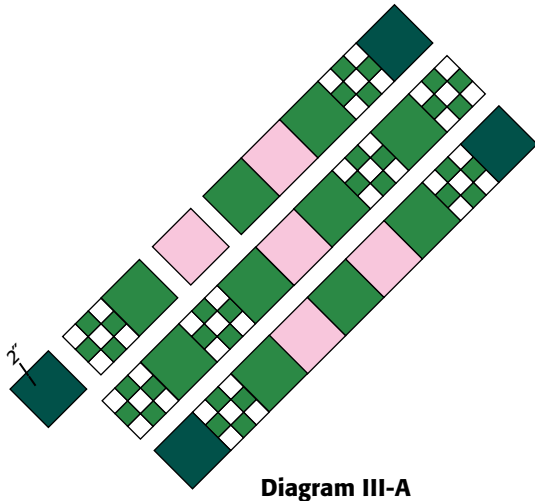


**Diagram II-A**

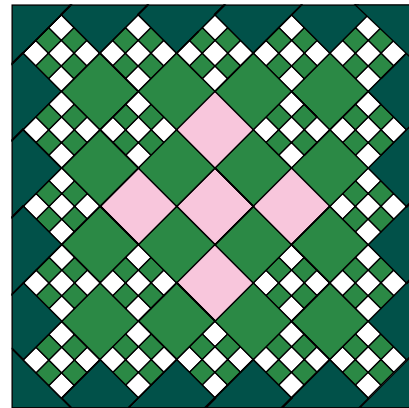
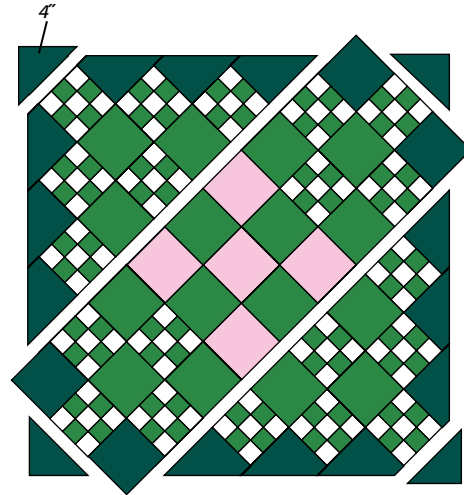
Sew rows together to make block unit (**Diagram II-B**). Make 2.

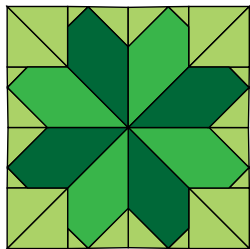


3 Sew 3 diagonal rows as shown, using dark green 2" squares, 9-patches, green swirl 2" squares, and fairy print 2" squares (**Diagram III-A**). Sew rows together to make block center (**Diagram III-B**).



4 Referring to **Diagram IV**, stitch block units to long sides of block center, aligning seams. Sew dark green 4" half-square triangles to corners. Trim block to 12½" square, centering.





# Lucky Clover Block

**Skill Level**  
CONFIDENT BEGINNER

**Finished Block Size**  
12" x 12"

**Cutting Instructions**  
(cut in order listed)

Light green print/texture (background)

8 squares  $3\frac{1}{2}$ " x  $3\frac{1}{2}$ "

8 squares  $2\frac{1}{2}$ " x  $2\frac{1}{2}$ "

8 squares  $1\frac{1}{2}$ " x  $1\frac{1}{2}$ "

Medium green print/texture and dark green print/texture (leaves)—cut from each:

4 rectangles  $3\frac{1}{2}$ " x  $6\frac{1}{2}$ "

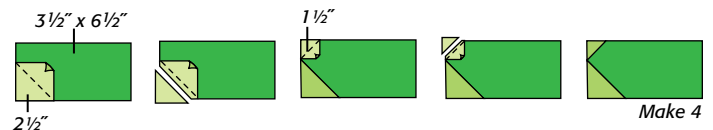
**Piecing the Block**

**1** Draw diagonal line on wrong side of light green  $2\frac{1}{2}$ " square. Referring to **Diagram I-A**, place marked square on corner of medium green rectangle, right sides together, aligning raw edges. Stitch on drawn line; trim away and discard excess fabric. Open and press. Using light green  $1\frac{1}{2}$ " square, repeat on adjoining corner to make medium pieced rectangle. Make 4. In similar manner, but reversing placement of light squares, make 4 dark pieced rectangles (**Diagram I-B**).

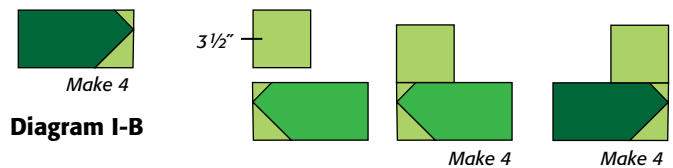
**2** Aligning as shown in **Diagram II**, stitch light  $3\frac{1}{2}$ " square to medium pieced rectangle to make medium pieced unit. Make 4. In same manner, but reversing placement of square, stitch light  $3\frac{1}{2}$ " square to dark pieced rectangle to make dark pieced unit. Make 4.

**3** On wrong side of medium pieced unit, draw a line from corner of  $3\frac{1}{2}$ " square to bottom corner of medium rectangle (**Diagram III**). Place marked medium pieced unit on dark pieced unit, right sides together, aligning raw edges. Stitch on drawn line; trim away and discard excess fabric. Open and press to make quarter-block. Make 4.

**4** Referring to **Diagram IV** and watching orientation, stitch 2 rows of 2 quarter-blocks each. Sew rows together to make Lucky Clover Block.

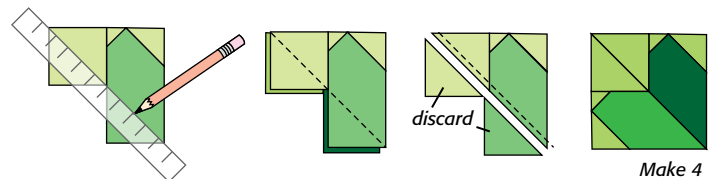


**Diagram I-A**

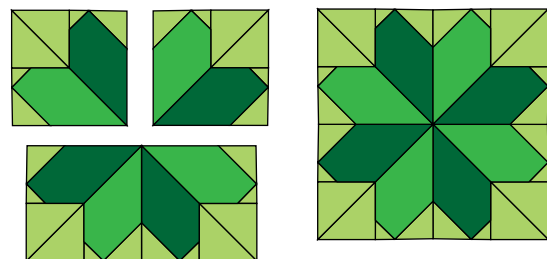


**Diagram I-B**

**Diagram II**



**Diagram III**



**Diagram IV**



# 40 Shades of Green

**SKILL LEVEL**  
**INTERMEDIATE**

**Finished Block Size**  
12" x 12"

**Note:** Templates A and B are at end of pattern. Template A is printed without seam allowance. Template B is for cutting paper-backed fusible web.

### Cutting Instructions

**Note:** Read through pattern before cutting.

Cream or white solid (block base)

1 square 13" x 13"

\*40 assorted green prints, florals, and mottles (scallops)

72 Template A

Paper-backed fusible web

72 Template B

See-through template plastic

Appliqué pressing sheet or parchment paper

\*Substitute other colors if you wish.

### Preparing the Scallops

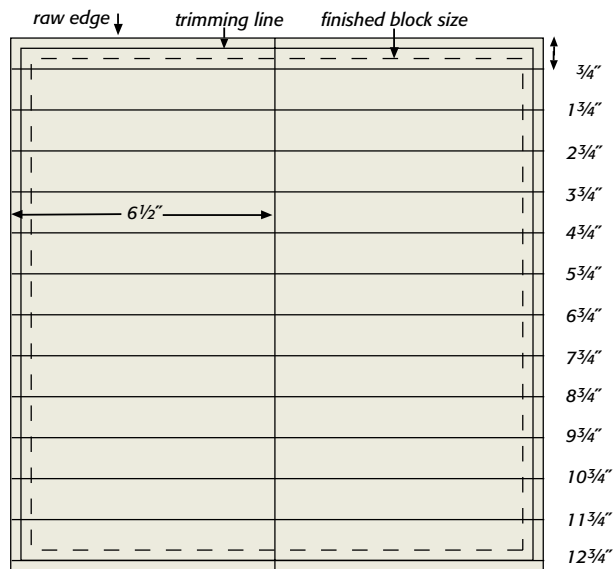
**1** To prepare Template A, trace on template plastic, including placement lines. Cut out directly on outer lines. Place plastic Template A on assorted green fabrics; mark around template. Cut out 72 fabric scallops and transfer placement lines to right side of each.

To prepare fusible-web B shapes, trace 72 on paper side of paper-backed fusible web. Cut out on drawn lines.

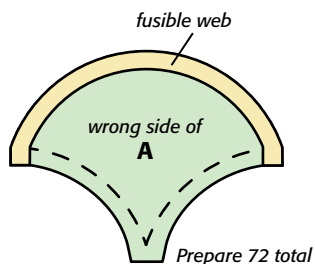
**2 Note:** Follow manufacturer's instructions for paper-backed fusible web. Place A, wrong side up, on appliqué pressing sheet or parchment paper. Align B with top curve and straight-side corners of A and fuse in place. To protect iron you may wish to fold pressing sheet or parchment paper over A and B before fusing. Remove paper from fusible web B when cool. Prepare 72 total scallops with fusible web (**Diagram I**).

### Making the Block

**3** Referring to **Diagram II**, draw a line across 13" cream/white square,  $\frac{3}{4}$ " from top raw edge. Draw a second line  $1\frac{3}{4}$ " from top raw edge. Continue in this manner to draw a total of 13 lines 1" apart; last line will be  $\frac{1}{4}$ " from bottom raw edge. Measure  $6\frac{1}{2}$ " from left edge of square and draw a line to mark vertical center. Block will be trimmed to  $12\frac{1}{2}$ " x  $12\frac{1}{2}$ " in Step 7 (finished size is 12" x 12").

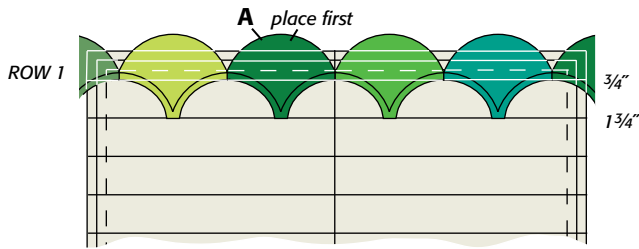


**Diagram II**



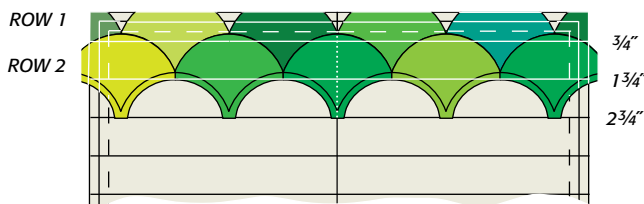
**Diagram I**

4 With appliqué sheet beneath top edge of square and referring to **Diagram III-A**, position first A on square, fusible side down, so that right edge of A aligns with vertical center line, bottom aligns with  $1\frac{3}{4}$ " line and bottoms of straight-sided corners align with  $\frac{3}{4}$ " line; fuse in place. Top curved edge of A will extend beyond top of square. Place second A next to first, straight sides touching, and with bottom and corners aligned in same way on lines; fuse in place. Continue in same manner to place and fuse As across width of base square. When you reach edges, reposition appliqué sheet to protect ironing surface at the sides of the square. Scallops will extend beyond top edge and sides; **trim** even with raw edges. Row 1 consists of 6 scallops.



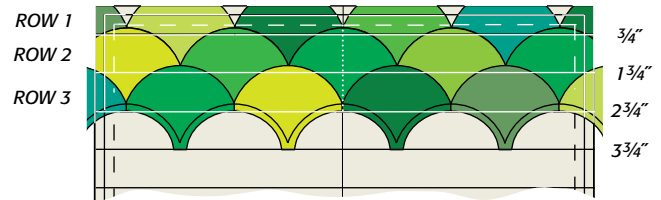
**Diagram III-A**

5 For Row 2, finger-press A in half vertically; use fold as placement guide. Referring to **Diagram III-B**, position A centered between two Row 1 As and with top curved edge just covering placement lines. Align bottom of A with  $2\frac{3}{4}$ " line and bottoms of straight-sided corners with  $1\frac{3}{4}$ " line. Being sure that Row 1 scallops lie flat, fuse A in place. In same manner, checking that straight sides touch, and corners and bottoms are aligned with correct lines, continue to add As to Row 2. Reposition appliqué sheet as needed to protect ironing surface at the sides of the base square. Edge scallops will extend beyond sides of base square; **trim** even with raw edges. Row 2 consists of 5 scallops.



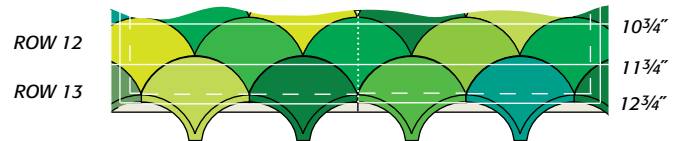
**Diagram III-B**

6 Referring to **Diagram III-C**, position and fuse Row 3 scallops, centered between and overlapping Row 2 scallops. There will be 6 scallops in Row 3.



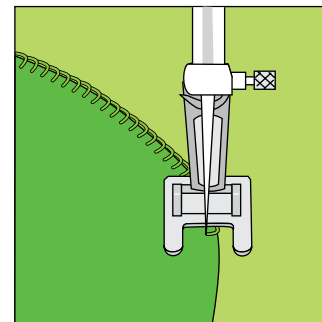
**Diagram III-C**

Continue in this manner, placing and fusing 13 rows (**Diagram IV**). Row 13 will extend beyond bottom edge and sides of base square; **trim** even.



**Diagram IV**

7 Using green thread and small machine blanket stitch (or any other combination of thread and stitch that you prefer), edge-stitch scallops (**Diagram V**). **Trim** block to  $12\frac{1}{2}$ " x  $12\frac{1}{2}$ ", centering. Machine-baste  $\frac{1}{8}$ " from edges of block to secure unfused areas of scallops in place until block is sewn into quilt.



**Diagram V**

**Optional:**

To reduce bulk in block you may wish to trim away unfused excess fabric behind scallops when block is complete. Be careful not to cut through top layer of fabric and be sure to leave  $\frac{1}{4}$ " seam allowance around all edge-stitching and basting.

